

## Firebox M4800 Hardware Guide

---

WatchGuard security appliances deliver unparalleled unified threat management, superior performance, ease of use, and value. Powerful subscription-based security services deliver in-depth defenses against advanced malware, ransomware, botnets, trojans, viruses, drive-by downloads, phishing and much more.

This guide introduces the Firebox M4800, a RoHS-compliant (lead-free) hardware product offered by WatchGuard. The Firebox M4800 consolidates critical network and security functions into a single, centrally managed device, and is ideal as the 'hub' for distributed, hub-and-spoke type deployment scenarios.

### Fireware OS

The Firebox M4800 device uses WatchGuard's next generation UTM OS — Fireware OS. Each Firebox M4800 device includes Fireware OS and delivers exceptional protection against today's sophisticated threats to make sure that your business stays connected. For more information on the features of Fireware OS, see [Fireware Help](#).

### About Your Hardware

#### Hardware Specifications

This table shows the hardware specifications for the WatchGuard Firebox M4800.

Processor	Intel Coffee Lake Xeon E-2176G
Storage	256 GB Solid State HDD
Memory: DDR4	16 GB
Power Supply	Dual power supplies 300W 100-240VAC/5-3A/50-60Hz
Dimensions	D = 46.8 cm (18.42") W = 43.1 cm (16.96") H = 4.4 cm (1.73")
Weight	8 kg (17.63 lbs)

#### Interface Specifications

This table shows the interface specifications for the WatchGuard M4800 as shipped.

Management Interface	1x 1000 Base TX (10/100/1000Mbps), RJ45 connector
Network Interfaces	8x 1000 Base TX (10/100/1000Mbps), RJ45 connector
I/O Interfaces	2 USB 3.0 1 RJ45 RS232 console port

The Firebox also has two slots where you can install additional interface modules. The supported interface modules are described in the [Hardware Description](#) section.

## Environmental Requirements

To safely install your Firebox, we recommend that you:

- Install it in a network rack.
- Put it in a secure area, such as a locked room, to block the device from people who do not have permission to use it.
- Connect it to a conditioned power supply to prevent damage from sudden power changes.

This table shows other environmental requirements for the M4800 appliance.

Operating Temperature	0° to 40°C (32° to 104°F)
Operating Humidity	5% to 90% non-condensing
Non-operating Temperature	-10° to 70°C (14° to 158°F)
Non-operating Humidity	5% to 90%, non-condensing

## Hardware Description

### Front

Front view of the Firebox:



Left front panel detail:



## Buttons and Indicators

### Power (⏻)

The power indicator is green when the device is powered on.

### Arm/Disarm (🛡️)

When the device is armed and ready to pass traffic, this indicator is green. When the device is powered on, but not ready to pass traffic, this indicator is red.

### Storage (🗄️)

When there is activity on the internal storage, this indicator is yellow.

### Power Button (⏻)

The Power button is lit to indicate power status. It is green when the Firebox is powered on, and red when power is available, but the Firebox is powered off.

When the Power button is red, press it to power on the Firebox.

When the Power button is green, press and hold the power button for five seconds to power off the Firebox. The Firebox does not power off if you briefly press the Power button.

### Reset Button

The Reset button, located to the left of the USB interfaces, resets the device to factory-default settings. To reset the device, see [Restore Factory Default Settings](#)

## Built-in Interfaces

The Firebox M4800 has eight built-in network interfaces, a management interface, two USB interfaces, and one serial console port.

### Dual USB interfaces

The device includes two USB interfaces. Connect a USB storage device for USB backup and restore, or to store a support snapshot. For more information, see [Fireware Help](#).

### Console port

An RJ45 connector for the serial (console) interface is located above the USB interfaces. You can connect to this serial interface to log in to the Fireware Command Line Interface.

For more information about the command line interface, see the current *Command Line Interface Reference* available on the Firebox documentation page at <https://www.watchguard.com/wgrd-help/documentation/xtm>.

### Management interface

The management interface, labeled  or **Mgmt**, is located to the right of the USB interfaces. You must connect to this interface to configure the Firebox when it starts with factory-default settings. The management interface is interface 24.

### RJ45 Ethernet interfaces

Interfaces 0 - 7 are RJ45 Ethernet interfaces that support link speeds of 10, 100, or 1000 Mbps. Each RJ45 interface has two indicators. The right indicator shows the interface connection status. The left indicator shows interface activity.

Indicator	Indicator Color	Interface Status
Connection (right)	Yellow	Link at 1000 Mbps
	Green	Link at 100 Mbps
	Not Lit	Link at 10 Mbps or no link
Activity (left)	Yellow, blinks	Power on, network activity

Indicator	Indicator Color	Interface Status
	Not Lit	Power off, no connections

## Interface Modules

To add more interfaces to your Firebox, you can install an interface module in an available interface module slot. You must install the interface module before you can configure the interfaces. For instructions to install or remove interface modules, see [Interface Module Installation](#).

Interface modules are not hot-swappable. To avoid damage to the system, power off the Firebox before you install or remove interface modules.

You can purchase these compatible interface modules from an authorized WatchGuard reseller:

- WatchGuard Firebox M 8 Port 1 Gb Copper Module — WatchGuard SKU WG8592
- WatchGuard Firebox M 8 Port SFP Fiber Module — WatchGuard SKU WG8593
- WatchGuard Firebox M 4 Port 10 Gb SFP+ Fiber Module — WatchGuard SKU WG8594
- WatchGuard Firebox M 2 Port 40 Gb QSFP+ Fiber Module — WatchGuard SKU WG8023

For each interface module, ports are numbered from 0-7, 0-3, or 0-1. The interface numbers that appear in the Firebox configuration depend on the number of ports on the interface module, and the interface module slot where the interface module is installed.

Installed in slot	Number of Ports	Modular Interface Port Numbers	Interface Numbers in Management Software
A	8	A0-A7	8-15
	4	A0-A3	8-11
	2	A0-A1	8-9
B	8	B0-B7	16-23
	4	B0-B3	16-19
	2	B0-B1	16-17

Indicators for the modular interfaces are described below.

8 Port 1G RJ45 Interface Module

8 Port 1G SFP Interface Module

4 Port 10G SFP+ Interface Module

2 Port 40Gb QSFP+ Fiber Module

For a list of compatible transceivers, see [Supported transceivers for Firebox and XTM Appliances](#) in the WatchGuard Knowledge Base.

## Rear

Rear view of the Firebox:



### *Cooling fans*

The fans decrease the internal temperature of the device. The fans start at maximum RPM when the Firebox is powered on. The device adjusts the fan speed based on the external temperature and device CPU load.

### *Power switch*

Controls the power supplied to the Firebox. The Power switch activates both power supplies.

### *AC receptacles*

Each AC receptacle accepts a detachable AC power cord supplied with the Firebox. Each power supply is a WatchGuard standard auto-sensing AC power supply.

### *Replaceable power supplies*

There are two power supplies on the Firebox M4800, each with a power indicator at the top. For instructions to install a replacement power supply, see [Power Supply Installation](#).

Power Indicator Color	Power Supply Status
Green flashing	Power is connected to at least one power supply, device is powered off
Green solid	Power is connected, device is powered on
Red flashing	Power is not connected or power supply failed, device is powered on
Not lit	Power is not connected, device is powered off

### *Alarm Reset button*

When the Firebox is powered on, if either power supplies fails or is not connected to a power source, an audible alarm sounds. To silence the alarm, press the alarm reset button, located to the left of the power supplies. After you silence the alarm the indicator for the failed power supply flashes red.

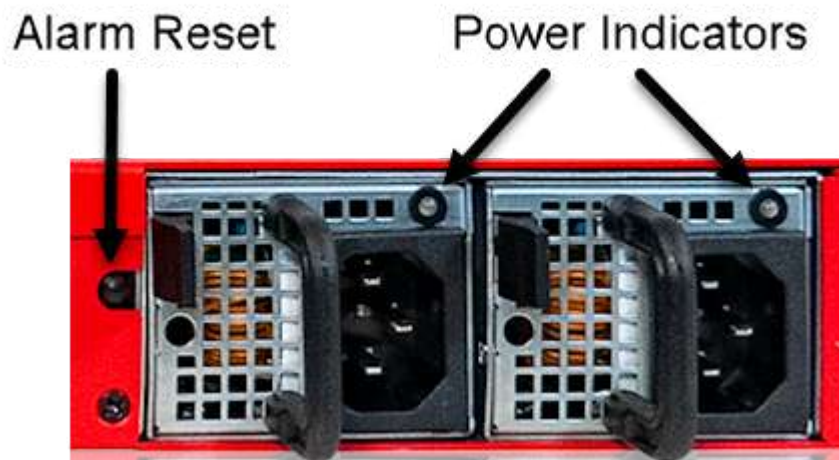

## Restore Factory Default Settings

If you ever need to, you can restore your Firebox to its factory-default settings. For example, if you do not know the administrator account passphrase or you want to start over with a new configuration, you can reset your device. Make sure you back up your device configuration before you reset your device in case you want to restore it in the future.

To reset your device:

1. Power off the device.
2. Press and hold the **Reset** button, while you briefly press the **Power** button on the front of the device to power it on.
3. Continue to hold the **Reset** button while the **Arm** indicator is red.
4. Continue to hold the **Reset** button while the **Arm** indicator slowly flashes green.
5. When the **Arm** indicator flashes green more rapidly, release the **Reset** button.
6. Wait until the **Arm** indicator starts to flash red.
7. Press and hold the **Power** button on the front of the device for five seconds to power off the device.
8. Briefly press the **Power** button on the front of the device to power it on.

## Hardware Installation

Your Firebox ships with a rack mount kit. It also supports user-installable components. This document includes instructions to install your Firebox and its components:

- Rack mount installation
- Interface module installation
- Power supply installation and replacement

## Rack Mount Installation

Each Firebox device ships with rack mount ears for installation in a network rack.

- Rack rail kit
  - 2 sliding rails

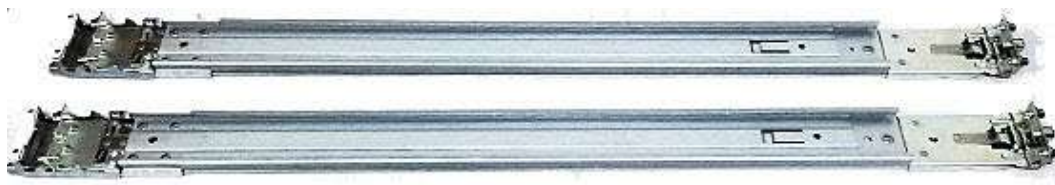

- 10 small screws and 8 large screws



- Front ear bracket kit
  - 2 front ear brackets



- 6 small screws and 2 large screws



## Precautions

When you install the device in a rack, make sure you consider these factors:

### *Elevated Operating Ambient Temperature*

If you install the device in a closed or multi-unit rack assembly, the operating ambient temperature of the rack environment might be greater than room ambient. Make sure the ambient temperature of the rack environment is within the certified operating range specified in this Hardware Guide.

### *Reduced Air Flow*

When you install the device in a rack, make sure that the amount of air flow required for safe operation of the equipment is not compromised.

### *Mechanical Loading*

When you mount the device in the rack, avoid hazardous conditions caused by uneven mechanical loading.

### *Circuit Overloading*

Make sure you connect the device to the power supply circuit in such a way that there is no overloading of the circuits, and no impact on overcurrent protection and supply wiring.

### *Reliable Grounding*

Make sure all rack-mounted equipment is correctly grounded. For example, make sure you use power strips instead of direct connections to the branch circuit.

Do not use your slide/rail mounted device as a shelf or work space.

Separate the inner rails from the outer rails

Attach the inner rails and front ear brackets to the Firebox

Attach the outer rails to the rack

Install alternate screws on the rails (if needed)

Install the Firebox in the rack

Remove the Firebox from the rack

## Interface Module Installation

You can install two additional interface modules in slots A and B of your Firebox. The supported interface modules are described in detail in the [Interface Modules](#) section.

Interface modules are not hot-swappable. To avoid damage to the system, power off the Firebox before you install or remove interface modules.

## Install an Interface Module

To install an interface module:

1. Disconnect the power cables from the Firebox.
2. Loosen the two captive screws on the slot cover.
3. Remove the slot cover to expose the interface slot.
4. Insert the interface module into the slot, and push it firmly into place.
5. Tighten the two captive screws on the interface module to attach the interface to the Firebox.
6. Reconnect the power cables to the Firebox.

*The Firebox starts automatically. When the Firebox starts, Fireware automatically detects all installed interfaces.*

## Remove an Interface Module

Before you remove an installed interface module, make sure that the interfaces on that module are not enabled in the Firebox configuration. You cannot manage a Firebox if an enabled interface has been removed.

To remove an installed interface module:



1. Disconnect the power cables from the Firebox.
2. Disconnect all network cables from the installed interface module.
3. Loosen the two screws on the installed interface module.
4. Slide the interface module out of the slot.
5. Place the removed interface module on an antistatic surface, or immediately install it in another slot.
6. Install a slot cover over the empty slot or install another interface module. The slot cover keeps dust out of the Firebox.

## Power Supply Installation and Replacement

The Firebox has two redundant hot-swappable power supplies. If a power supply fails, you can replace it while the Firebox is powered by the other power supply.

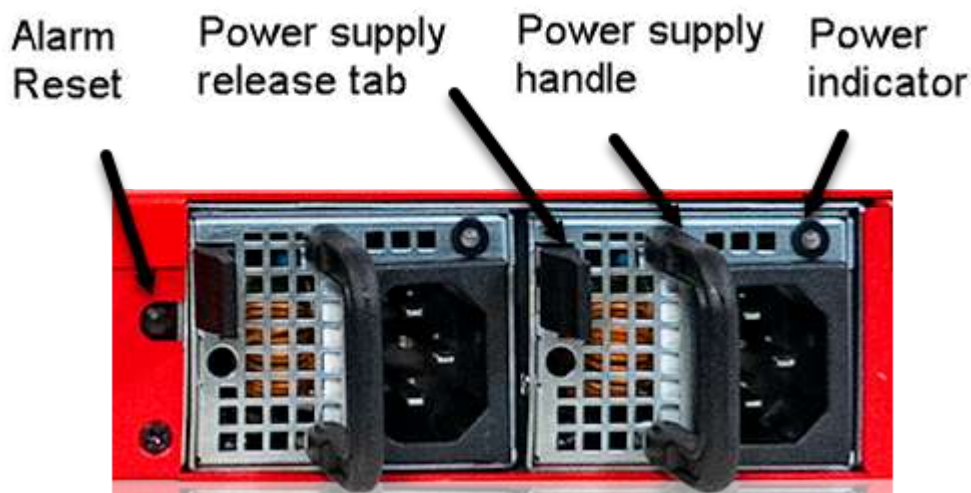

To replace a power supply:

1. Use the power indicator to identify the failed power supply. If the device is powered on, the indicator on the failed power supply flashes red after you reset the audible alarm.
2. Disconnect the power cable from the power supply you want to replace.
3. Find the release tab, located on the left side of the power supply.
4. Firmly push the release tab to the right, while you use the power supply handle to pull the power supply out of the slot.
5. Slide the replacement power supply into the open slot.
6. Press firmly on the face of the power supply until it is flush with the back of the Firebox. If the replacement is successful, the power indicator light for the new power supply is green.

You can purchase a replacement power supply from an authorized WatchGuard reseller.

- WatchGuard Firebox M4800 Hot Swap Power Supply — WatchGuard SKU WG9012

## Notices

---

All WatchGuard products are designed and tested to meet strict safety requirements. These requirements include product safety approvals and other global compliance standards. Read these instructions carefully before you operate the product, and refer to them as needed for continued safe operation of your product.

### Product Safety Certification

The WatchGuard product is safety certified under the following standards:

- CAN/CSA C22.2 No.60950-1-07, Second Edition 2014-10
- UL 60950-1, Second Edition 2014-10-14
- IEC 60950-1, 2005+A1:2009+A2:2013
- IEC 62368-1: 2014 2nd edition
- EN 60950-1:2006+A11:2009+A1:2010+A12:2011+A2:2013

### Safety Warning

- Do not place objects on the power cord.
- Do not obstruct the ventilation openings. These openings prevent overheating of the machine.
- Never push objects of any kind into slots or openings on this equipment. Making a contact with a voltage point or shorting out a part may result in fire or electrical shock.
- When removing or installing an appliance, follow the general installation safety instructions.
- You must disconnect the AC power cord from the Firebox before you remove the cover of the Firebox for any reason.
- There is risk of explosion if the battery is replaced by an incorrect type. Dispose of used batteries according to the manufacturer's instructions.
- 警示 本電池如果更換不正確會有爆炸的危險，請勿自行更換電池

### Disclaimer

WatchGuard shall not be held liable if the end user alters, modifies, or repairs any WatchGuard hardware appliance.

### Hinweise Zur Sicherheit

Alle WatchGuard Produkte werden entwickelt und getestet, um strenge Sicherheitsanforderungen zu erfüllen. Diese Anforderungen umfassen Produktsicherheit Zulassungen und andere globale Compliance-Standards. Bitte lesen Sie die folgenden Anweisungen sorgfältig, bevor Sie das Produkt, und bezeichnen sie als notwendig, um den sicheren Betrieb des Geräts zu gewährleisten. Weitere Informationen finden Sie in der elektronischen Hardware Guide.

Die WatchGuard Produkt ist Sicherheit unter den folgenden Normen zertifiziert

- CAN/CSA C22.2 No.60950-1-07, Second Edition 2014-10
- UL 60950-1, Second Edition 2014-10-14
- IEC 60950-1:2005+A1:2009+A2:2013
- IEC 62368-1: 2014 2nd edition
- EN 60950-1:2006+A11:2009+A1:2010+A12:2011+A2:2013

## Sicherheitshinweis

- Legen Sie keine Gegenstände auf das Netzkabel.
- Verdecken Sie nicht die Lüftungsöffnungen. Diese Öffnungen verhindern eine Überhitzung der Maschine.
- Stecken Sie niemals Gegenstände jeglicher Art in die Schlitze oder Öffnungen des Geräts stecken. Der Kontakt mit einem spannungsführenden Punkt oder das Kurzschließen eines Bauteils kann zu einem Brand oder elektrischen Schlag führen.
- Beim Entfernen oder Installieren eines Gerätes, nach den allgemeinen Installation Sicherheitshinweise.

## Avis de sécurité

Tous les produits de WatchGuard sont conçus et testés pour répondre à des exigences de sécurité strictes. Ces exigences incluent l'homologation de la sécurité du produit et la conformité à d'autres normes globales. Lisez ces instructions avec attention avant de mettre en route l'appareil et reportez-vous-y au besoin pour assurer une utilisation sûre de l'appareil.

## Certifications de sécurité du produit

Les produits de WatchGuard répondent aux normes suivantes;

- CAN/CSA C22.2 No.60950-1-07, Second Edition 2014-10
- UL 60950-1, Second Edition 2014-10-14
- IEC 60950-1:2005+A1:2009+A2:2013
- IEC 62368-1: 2014 2nd edition
- EN 60950-1:2006+A11:2009+A1:2010+A12:2011+A2:2013

## Avertissement de sécurité

- Ne placez aucun objet sur le cordon d'alimentation.
- N'obstruez pas les ouvertures de ventilation. Ces ouvertures préviennent la surchauffe de l'appareil.
- N'insérez jamais d'objet de quelque sorte dans les fentes d'ouverture de cet équipement. Si vous faites contact avec un point sous tension ou court-circuitez un composant, cela peut causer un incendie ou un choc électrique.
- Si l'appareil est fourni avec un câble d'alimentation électrique à trois points (avec prise terre), le câble d'alimentation doit impérativement être branché sur une prise à trois points correctement mise à la terre.
- Quand vous enlevez ou désinstallez un équipement, suivez les instructions générales de sécurité fournies dans ce Guide Matériel pour éviter toute blessure ou dégât à l'appareil.
- La batterie au lithium utilisée dans cet appareil de sécurité réseau ne peut pas être remplacée par l'utilisateur final. Renvoyez cet appareil à un centre de service autorisé par WatchGuard pour un remplacement avec une batterie du même type ou de type équivalent recommandé par le fabricant. Si pour une raison quelconque la batterie ou cet équipement doit être mis au rebus, suivez les recommandations du fabricant de la batterie.

## Aviso De Seguridad

Todos los productos WatchGuard están diseñados y probados para satisfacer estrictos requisitos de seguridad. Estos requisitos incluyen la homologación de productos de seguridad y otras normas de cumplimiento global. Por favor, lea atentamente las siguientes instrucciones antes de utilizar el producto, y se refieren a ellos como sea necesario para garantizar el funcionamiento seguro y continuo de su producto. Información adicional se puede encontrar en la Guía del usuario electrónica.

## Certificación de seguridad del producto

El producto tiene certificación de seguridad WatchGuard bajo las siguientes normas:

- CAN/CSA C22.2 No.60950-1-07, Second Edition 2014-10
- UL 60950-1, Second Edition 2014-10-14
- IEC 60950-1:2005+A1:2009+A2:2013
- IEC 62368-1: 2014 2nd edition
- EN 60950-1:2006+A11:2009+A1:2010+A12:2011+A2:2013

## Advertencia de seguridad

- No coloque objetos sobre el cable de alimentación.
- No obstruya las aberturas de ventilación. Estas aberturas evitan el sobrecalentamiento de la máquina.
- Nunca introduzca objetos de ningún tipo en las ranuras o aberturas del equipo. El contacto con puntos de voltaje o el cortocircuito de una pieza podría provocar un incendio o una descarga eléctrica.
- Al extraer o instalar un electrodoméstico, siga las instrucciones generales de instalación de seguridad.

## CE Notice

The  symbol on your WatchGuard Technologies equipment indicates that it is in compliance with the Electromagnetic Compatibility (EMC) directive and the Low Voltage Directive (LVD) of the European Union (EU).

## RoHS Statement

The member states of the European Union approved directive 2002/95/EC, Restrictions of Hazardous Substances ("RoHS directive") that became valid on July 1, 2006. It states that all new electrical and electronic equipment put on the market within the member states must not contain certain hazardous materials. This device complies with the European Union's RoHS directive 2002/95/EC and similar regulations that may be adopted by other countries for European Sales.

## WEEE Statement

WEEE is a general set of requirements dictated in the EU Directive 2002/96/EC. This Directive mandated that member EU countries enact regulations governing the Waste of Electrical and Electronic Equipment (WEEE). The Directive, and its individual transpositions into specific country laws and legislation, is aimed at the reduction of WEEE through reuse, recovery, and recycling of WEEE.

WatchGuard is working in partnership with our European Union (EU) distribution partners to ensure that our products are in compliance with the WEEE statutes, and that the recovery of our product per the specific EU country legislative requirements is seamless for our product's end users. If you have a WatchGuard product that is at its end of life and needs to be disposed of, please contact WatchGuard Customer Care Department at:

U.S. Customers: 877.232.3531 International Customers: +1.206.613.0456

WatchGuard is reasonably confident that our products do not contain any substances or hazardous materials presently banned by any legislation, and do not present a risk due to hazardous materials. WEEE recovery professionals should also note that these products do not have any materials that are of particular high value in their individual form.

## REACH

The new EU chemicals policy REACH (Registration, Evaluation, Authorization and restriction of Chemicals) came into effect on June 1, 2007. REACH is Europe's new chemicals legislation, which is applicable in all 27 EU Member States as well as the EFTA European Economic Area (EEA). REACH creates a new system for gathering information, assessing risks to human health and the environment, and authorizing or restricting the marketing and use of chemicals produced or supplied in the EEA. REACH has an impact on EEA producers and importers of finished products and users of chemicals in the course of industrial or professional activities.

WatchGuard supports the overall REACH objective of improving the protection of human health and the environment and will meet all applicable REACH requirements. WatchGuard is strongly committed to working with our customers and supply chain to define and implement the REACH requirements and ensure a smooth transition to compliance.

One of the REACH requirements is that manufacturers and importers have the duty to register substances they are producing or importing. In accordance with the regulations, the products of WatchGuard do not need to be registered for the following reasons:

- WatchGuard does not import more than 1 metric ton per year of a substance as defined by REACH.
- WatchGuard products are non-chemical products that are not designed to release any substance under normal and reasonably predictable application.
- Our products do not contain the listed substances at more than 0.1% by weight of the whole product/part.

## Taiwan RoHS

設備名稱：次世代防火牆，型號（型式）：CL48AE24, Firebox M4800 Equipment name Type designation (Type)						
單元 Unit	限用物質及其化學符號 Restricted substances and its chemical symbols					
	鉛Lead (Pb)	汞Mercury (Hg)	鎘Cadmium (Cd)	六價鉻Hexavalent chromium (Cr <sup>6+</sup> )	多溴聯苯Polybrominated biphenyls (PBB)	多溴二苯醚Polybrominated diphenyl ethers (PBDE)
印刷電路板 元件 PCBA	-	○	○	○	○	○
風扇 FAN	○	○	○	○	○	○
金屬機構件 ME metal part	○	○	○	○	○	○
塑膠機構件 ME plastic part	○	○	○	○	○	○
配件(例：電 源線等) Accessory (cable, etc.)	-	○	○	○	○	○
固態硬碟 HDD	-	○	○	○	○	○
<p>備考1. “超出0.1 wt %” 及 “超出0.01 wt %” 係指限用物質之百分比含量超出百分比含量基準值。</p> <p>Note 1: “Exceeding 0.1 wt %” and “exceeding 0.01 wt %” indicate that the percentage content of the restricted substance exceeds the reference percentage value of presence condition.</p> <p>備考2. “○” 係指該項限用物質之百分比含量未超出百分比含量基準值。</p> <p>Note 2: “○” indicates that the percentage content of the restricted substance does not exceed the percentage of</p> <p>備考3. “-” 係指該項限用物質為排除項目。</p> <p>Note 3: The “-” indicates that the restricted substance corresponds to the exemption.</p>						

## Limited Hardware Warranty

This Limited Hardware Warranty (the “Warranty”) applies to the enclosed hardware product, not including any associated software, which is licensed pursuant to a separate end-user license agreement and warranty (the “Product”). BY USING THE PRODUCT, YOU (either an individual or a single entity) AGREE TO THE TERMS HEREOF.

If you do not agree to these terms, please return this package, along with proof of purchase, to the authorized dealer from which you purchased it for a full refund. WatchGuard Technologies, Inc. (“WatchGuard”) and you agree as set forth below or on the reverse side of this card, as applicable.

1. LIMITED WARRANTY. WatchGuard warrants that upon delivery and for one (1) year thereafter (the “Warranty Period”): (a) the Product will be free from material defects in materials and workmanship, and (b) the Product, when properly installed and used for its intended purpose and in its intended operating environment, will perform substantially in accordance with

WatchGuard applicable specifications.

This warranty does not apply to any Product that has been: (i) altered, repaired or modified by any party other than WatchGuard except for the replacement or inclusion of specified components authorized in, and performed in strict accordance with, documentation provided by WatchGuard; or (ii) damaged or destroyed by force majeure events, accidents, power spikes or similar events or by any intentional, reckless or negligent acts or omissions of any party. You may have additional warranties with respect to the Product from the manufacturers of Product components. However, you agree not to look to WatchGuard for, and hereby release WatchGuard from any liability for, performance of, enforcement of, or damages or other relief on account of, any such warranties or any breach thereof.

2. **REMEDIES.** If any Product does not comply with the WatchGuard warranties set forth in Section 1 above, WatchGuard will, following the receipt of the product you claim is defective and at its option, either (a) repair the Product, or (b) replace the Product with a like or similar product; provided, that you will be responsible for returning the Product and for all costs of shipping and handling. Repair or replacement of the Product shall not extend the Warranty Period. Any Product, component, part or other item replaced by WatchGuard becomes the property of WatchGuard. WatchGuard shall not be responsible for return of or damage to any software, firmware, information or data contained in, stored on, or integrated with any returned Products.
3. **DISCLAIMER AND RELEASE.** THE WARRANTIES, OBLIGATIONS AND LIABILITIES OF WATCHGUARD, AND YOUR REMEDIES, SET FORTH IN PARAGRAPHS 1 AND 2 ABOVE ARE EXCLUSIVE AND IN SUBSTITUTION FOR, AND YOU HEREBY WAIVE, DISCLAIM AND RELEASE ANY AND ALL OTHER WARRANTIES, OBLIGATIONS AND LIABILITIES OF WATCHGUARD AND ALL OTHER RIGHTS, CLAIMS AND REMEDIES YOU MAY HAVE AGAINST WATCHGUARD, EXPRESS OR IMPLIED, ARISING BY LAW OR OTHERWISE, WITH RESPECT TO ANY NONCONFORMANCE OR DEFECT IN THE PRODUCT (INCLUDING, BUT NOT LIMITED TO, ANY IMPLIED WARRANTY OF MERCHANTABILITY OR FITNESS FOR A PARTICULAR PURPOSE, ANY IMPLIED WARRANTY ARISING FROM COURSE OF PERFORMANCE, COURSE OF DEALING, OR USAGE OF TRADE, ANY WARRANTY OF NONINFRINGEMENT, ANY WARRANTY OF UNINTERRUPTED OR ERROR-FREE OPERATION, ANY OBLIGATION, LIABILITY, RIGHT, CLAIM OR REMEDY IN TORT, WHETHER OR NOT ARISING FROM THE NEGLIGENCE (WHETHER ACTIVE, PASSIVE OR IMPUTED) OR FAULT OF WATCHGUARD OR FROM PRODUCT LIABILITY, STRICT LIABILITY OR OTHER THEORY, AND ANY OBLIGATION, LIABILITY, RIGHT, CLAIM OR REMEDY FOR LOSS OR DAMAGE TO, OR CAUSED BY OR CONTRIBUTED TO BY, THE PRODUCT).
4. **LIMITATION AND LIABILITY.** WATCHGUARD'S LIABILITY (WHETHER ARISING IN CONTRACT (INCLUDING WARRANTY), TORT (INCLUDING ACTIVE, PASSIVE OR IMPUTED NEGLIGENCE AND STRICT LIABILITY AND FAULT) OR OTHER THEORY) WITH REGARD TO ANY PRODUCT WILL IN NO EVENT EXCEED THE PURCHASE PRICE PAID BY YOU FOR SUCH PRODUCT. THIS SHALL BE TRUE EVEN IN THE EVENT OF THE FAILURE OF ANY AGREED REMEDY. IN NO EVENT WILL WATCHGUARD BE LIABLE TO YOU OR ANY THIRD PARTY (WHETHER ARISING IN CONTRACT (INCLUDING WARRANTY), TORT (INCLUDING ACTIVE, PASSIVE OR IMPUTED NEGLIGENCE AND STRICT LIABILITY AND FAULT) OR OTHER THEORY) FOR COST OF COVER OR FOR ANY INDIRECT, SPECIAL, INCIDENTAL, OR CONSEQUENTIAL DAMAGES (INCLUDING WITHOUT LIMITATION LOSS OF PROFITS, BUSINESS, OR DATA) ARISING OUT OF OR IN CONNECTION WITH THIS WARRANTY OR THE USE OF OR INABILITY TO USE THE PRODUCT, EVEN IF WATCHGUARD HAS BEEN ADVISED OF THE POSSIBILITY OF SUCH DAMAGES. THIS SHALL BE TRUE EVEN IN THE EVENT OF THE FAILURE OF ANY AGREED REMEDY.
5. **MISCELLANEOUS PROVISIONS.** This Warranty will be governed by the laws of the state of Washington, U.S.A., without reference to its choice of law rules. The provisions of the 1980 United Nations Convention on Contracts for the International Sales of Goods, as amended, shall not apply. You agree not to directly or indirectly transfer the Product or use of the product or associated documentation to any country to which such transfer would be prohibited by the U.S. Export laws and regulations. If any provision of this Warranty is found to be invalid or unenforceable, then the remainder shall have full force and effect and the invalid provision shall be modified or partially enforced to the maximum extent permitted by law to effectuate the purpose of this Warranty. This is the entire agreement between WatchGuard and you relating to

the Product, and supersedes any prior purchase order, communications, advertising or representations concerning the Product AND BY USING THE PRODUCT YOU AGREE TO THESE TERMS. IF THE PRODUCT IS BEING USED BY AN ENTITY, THE INDIVIDUAL INDICATING AGREEMENT TO THESE TERMS BY USING THE PRODUCT REPRESENTS AND WARRANTS THAT (A) SUCH INDIVIDUAL IS DULY AUTHORIZED TO ACCEPT THE WARRANTY ON BEHALF OF THE ENTITY AND TO BIND THE ENTITY TO THE TERMS OF THIS WARRANTY; (B) THE ENTITY HAS THE FULL POWER, CORPORATE OR OTHERWISE, TO ENTER INTO THE WARRANTY AND PERFORM ITS OBLIGATIONS UNDER THE WARRANTY AND; (C) THE WARRANTY AND THE PERFORMANCE OF THE ENTITY'S OBLIGATIONS UNDER THE WARRANTY DO NOT VIOLATE ANY THIRD-PARTY AGREEMENT TO WHICH THE ENTITY IS A PARTY.

No change or modification of the Warranty will be valid unless it is in writing and is signed by WatchGuard.

## Declaration of Conformity



## DECLARATION OF CONFORMITY

**WatchGuard Technologies, Inc.**  
**505 Fifth Ave. S., Suite 500**  
**Seattle, WA 98104-3892 USA**

**WatchGuard Technologies Inc. hereby declares that the product(s) listed below conform to the European Union directives and standards identified in this declaration.**

**Product(s):**

WatchGuard Models: Firebox M4800  
 Hardware Model: CL48AE24

**EU Directive(s):**

Low Voltage (2014/35/EU)  
 Electromagnetic Compatibility (2014/30/EU)  
 RoHS(2015/863/EU)  
 WEEE Directive 2012/19/EU  
 REACH EC 1907/2006  
 CNS 15663第5 節「含有標示」(102 年)

**Standard(s):**

**Safety:** EN60950-1:2006+A11:2009+A1:2010+A12:2011+A2:2013  
 EN 62368-1:2014/A11:2017  
 CNS14336-1(099年版)

**Emission:** CNS13438(95年完整版)  
 FCC Part 15, Subpart B Class A  
 ICES-003 Issue 6: 2016 (updated April 2019) Class A  
 ANSI C63.4-2014  
 VCCI-CISPR 32: 2016 / CISPR 32:  
 2015+C1:2016  
 EN 55032:2015+AC:2016  
 AS/NZS CISPR 32: 2015 Class A  
 CISPR32:2015 +C1:2016 Class A  
 EN 61000-3-2: 2014 Class A  
 EN 61000-3-3: 2013

**Immunity:** EN 55024: 2010 +A1: 2015  
 EN 61000-4-2: 2009  
 EN 61000-4-3: 2006 +A1: 2008 +A2: 2010  
 EN 61000-4-4: 2004  
 EN 61000-4-5: 2006  
 EN 61000-4-6: 2009  
 EN 61000-4-8: 2010  
 EN 61000-4-11: 2004

*Laurence Huang*



Signature:  
 Full Name: Laurence Huang  
 Position: Manufacturing Program Manager  
 Date: 24 Mar 2020

*© 2021 WatchGuard Technologies, Inc. All rights reserved. WatchGuard and the WatchGuard logo are registered trademarks or trademarks of WatchGuard Technologies in the United States and/or other countries. All other tradenames are the property of their respective owners.*